

# BFR 200 Series Fingerprint Readers



## Specifications

	RBH-BFR-200-S	RBH-BFR-200-M
Templates	1900	1900
Integrated Proximity Reader	125Hz Multi-technology	MIFARE (Read only)
PC to Reader/ Panel to Reader	Ethernet (CAT5) / Wiegand (6 Cond. Shielded 18 AWG)	
Dimensions/ Weight	5.7" (145 mm) Wide x 4.92" (125 mm) High x 1.3" (33mm) Deep / 12 oz. (340 g.)	
Operating Temperature/ Humidity	32° F to +131° F (0° C to +55° C) / 0 - 95% RH	
Power Requirements	DC 9~24V, 1A	
Sensor (Resolution)/ Template Size	Optical (500 DPI) / 352 bytes	
Authentication Time Speed	≤2 sec	
False Rejection/ Acceptance Rate	0.01% / 0.001%	
Features	LCD Display: 128 x 64 pixels; 2 LEDs; 10 number keys; 6 function keys; 1 bell button	

Innovative system integrated fingerprint readers by RBH are available with Multi-technology MIFARE proximity readers. Users will benefit from its unparalleled performance, ease-of-use, precision and fast matching speed.

This Fingerprint reader features a highly accurate optical sensor with automatic finger detection (no need to enter PINs). The user will also benefit from the advanced matching algorithm and audio-visual indications from acceptance & rejection of fingerprints.

\*Specifications are subject to change without notice.

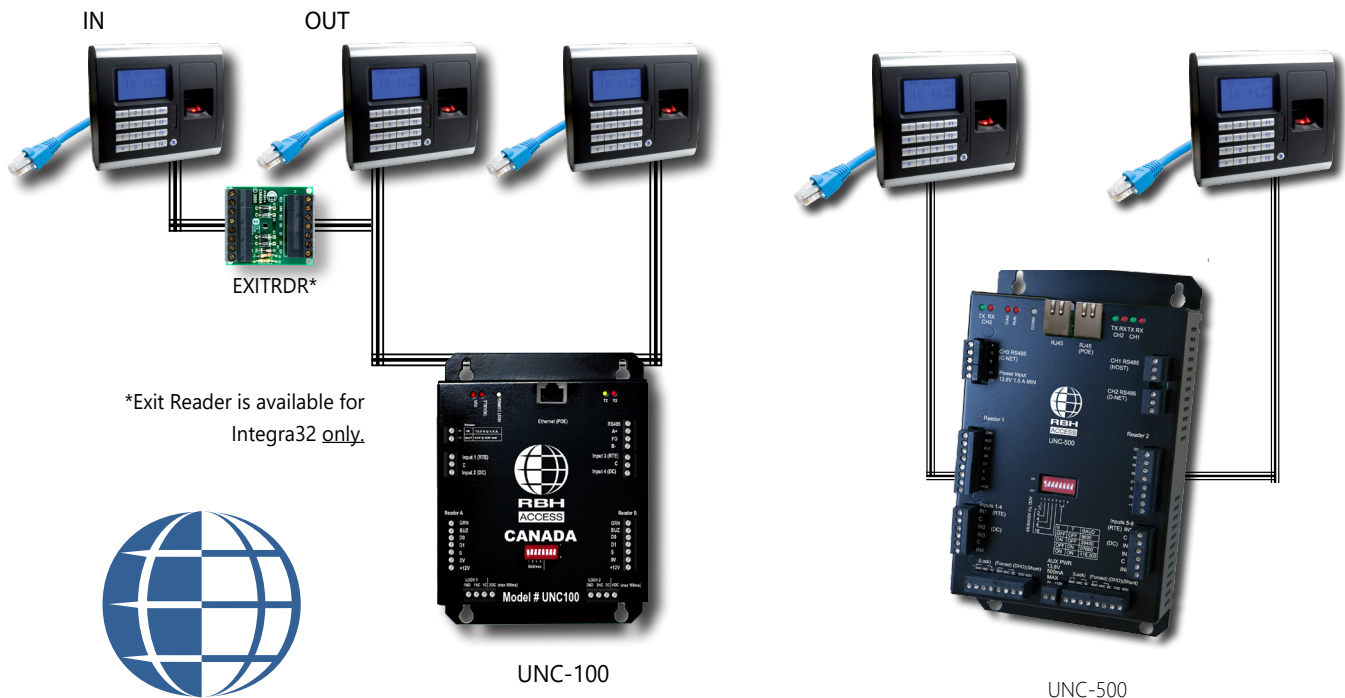

\*Exit Reader is available for Integra32 only.



[WWW.RBH-ACCESS.COM](http://WWW.RBH-ACCESS.COM)

© RBH Access Technologies, Inc. 2016